

## Dimensions

The GeoSmart EPDM membrane is 1.00mm thick and has a weight of 1.00 kg/m<sup>2</sup>. It is available in several sizes, to meet the requirements of any silo or heap. Rolls are wound on a 2.2 m core and are delivered on pallets. Please contact your local distributor for specific projects.



[ASK FOR OUR LIST OF SILAGE ROLL SIZES](#)

## Usage details

The reduction of air intake is critical to prevent silage fermentation within the silo/heap. We recommend to gradually fold the EPDM membrane and the biological protection film (if applicable) at the silo/heap head as needed each day and to maintain a clean front. The surroundings of the silage must also be cleaned daily.

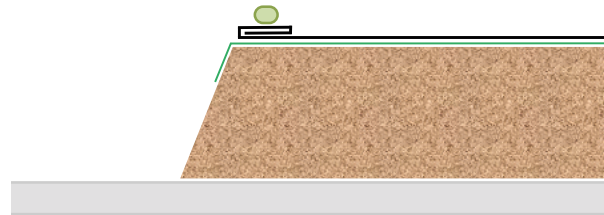

When a section has been completely utilized, fold and roll up the membrane for storage until the next season. If necessary, wash the membrane beforehand with a power water washer. Store the rolls at a height to avoid contact with rodents.



## Maintenance and repair

The GeoSmart EPDM membrane requires little or no maintenance. We recommend, however, to check its general condition on a regular basis and to repair it immediately if damage is observed. Repairs can be easily carried out using Firestone EasySealant, even after several years of exposure.

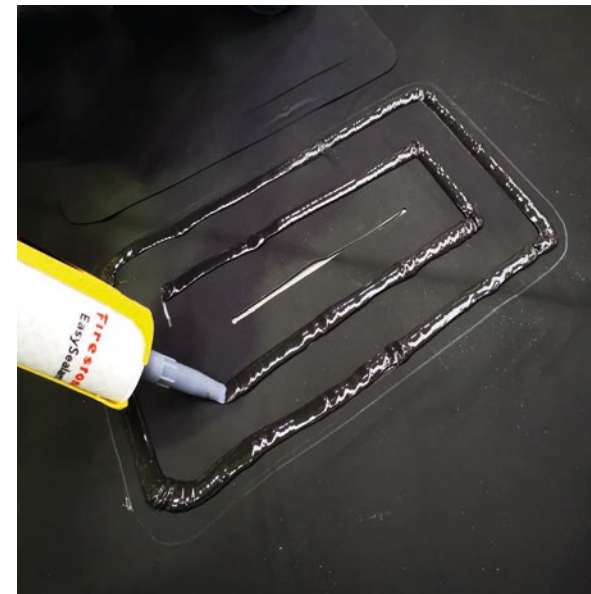

# Firestone

## GeoSmart EPDM

Robust and durable covers for quality silage



Firestone roofing, lining and wall systems are becoming Elevate.

LEARN MORE

 ELEVATE



Contact us for more information

**0800 109 093**  
or 021 280 7266

Authorised importer and distributor of Firestone Building Products

Email: [vaughan@cosio.co.nz](mailto:vaughan@cosio.co.nz) [www.cosio.co.nz](http://www.cosio.co.nz)

**GEOSMART**

Lining for life™

## Successful silage

Protecting stored forage from the effects of moisture and oxygen is key for the health and profitability of a livestock farm. This is equally important on biogas facilities, to avoid a loss of energy.

Firestone's GeoSmart EPDM membrane offers a simple, durable and sustainable solution for silage cover applications, both for bunker silos and silage heaps.



## Firestone quality

Firestone, a world leader in the rubber industry, produces waterproof membranes of excellent quality. GeoSmart EPDM is a robust, durable and elastic membrane that is ideally suited for agricultural applications.

Firestone Building Products is part of the Bridgestone Corporation, the world's largest tire and rubber company.



## Advantages of GeoSmart EPDM

- **Robust:** the covered silage can be walked over without any risk of damaging the membrane.
- **Durable:** resistant to UV exposure and weatherproof, the membrane can be re-used for several seasons.
- **Very low permeability to liquids and gases:** optimal silage preservation quality.
- **Flexible (-45°C) and elastic (> 300%):** the implementation is easy and the excellent contact with the support ensures maximum sealing.
- **Quick installation:** available in large sheets, the membrane easily adapts to the dimensions of the silo or heap. Its weight eliminates the use of tires and reduces the amount of ballast needed.
- **Easy to repair:** simple gluing, even after several years of exposure.
- **Environmentally friendly:** GeoSmart EPDM is a chemically inert membrane that does not release pollutants into the air or in the water. Re-using it over several years substantially reduces the waste generated by the farm or biogas facility.
- **High friction angle:** facilitates the installation and reduces the risk of accidents by slipping.
- **Self-extinguishing:** the GeoSmart EPDM membrane stops burning when removed from the heat source.

## Silo/heap preparation

CLEANING, COMPACTION, and SEALING are the three most important factors for the optimization of a silo/heap.

Clean the storage area. Pack the forage in layers of 15 to 20 cm to eliminate as much air as possible and to obtain a smooth surface (without wheel tracks).

## Installation

1. Pre-cut the rolls to a length equivalent to the width of the silo/heap (+ 1.0 m) for installing in tiles.
2. Install a biological protection film (40 µm). This step is not needed for biogas applications.
3. Unroll the membrane over the width of the silo/heap, leaving an outside edge of 0.5 m.
4. Unfold the membrane.
5. Place the next panel with an overlap of 20 cm (tiling). Repeat steps 3 to 5 to the end of the silo/heap.
6. Install continuous ballast along the entire perimeter of the silo/heap and transversely on the overlapping areas (maximum inter-distance of 10.5 m).

*Note: In regions of high winds, additional weighting may be necessary.*

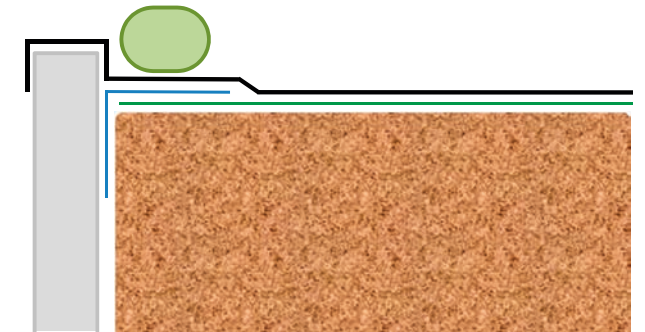

Lateral detail of a bunker silo

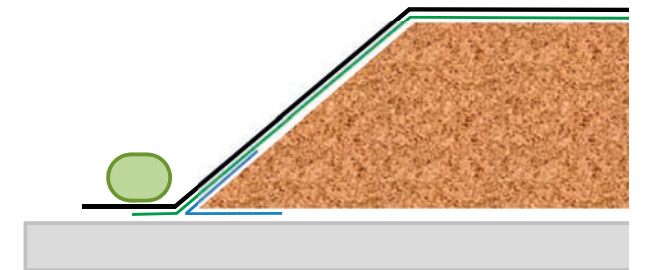

Lateral detail of a silage heap

